

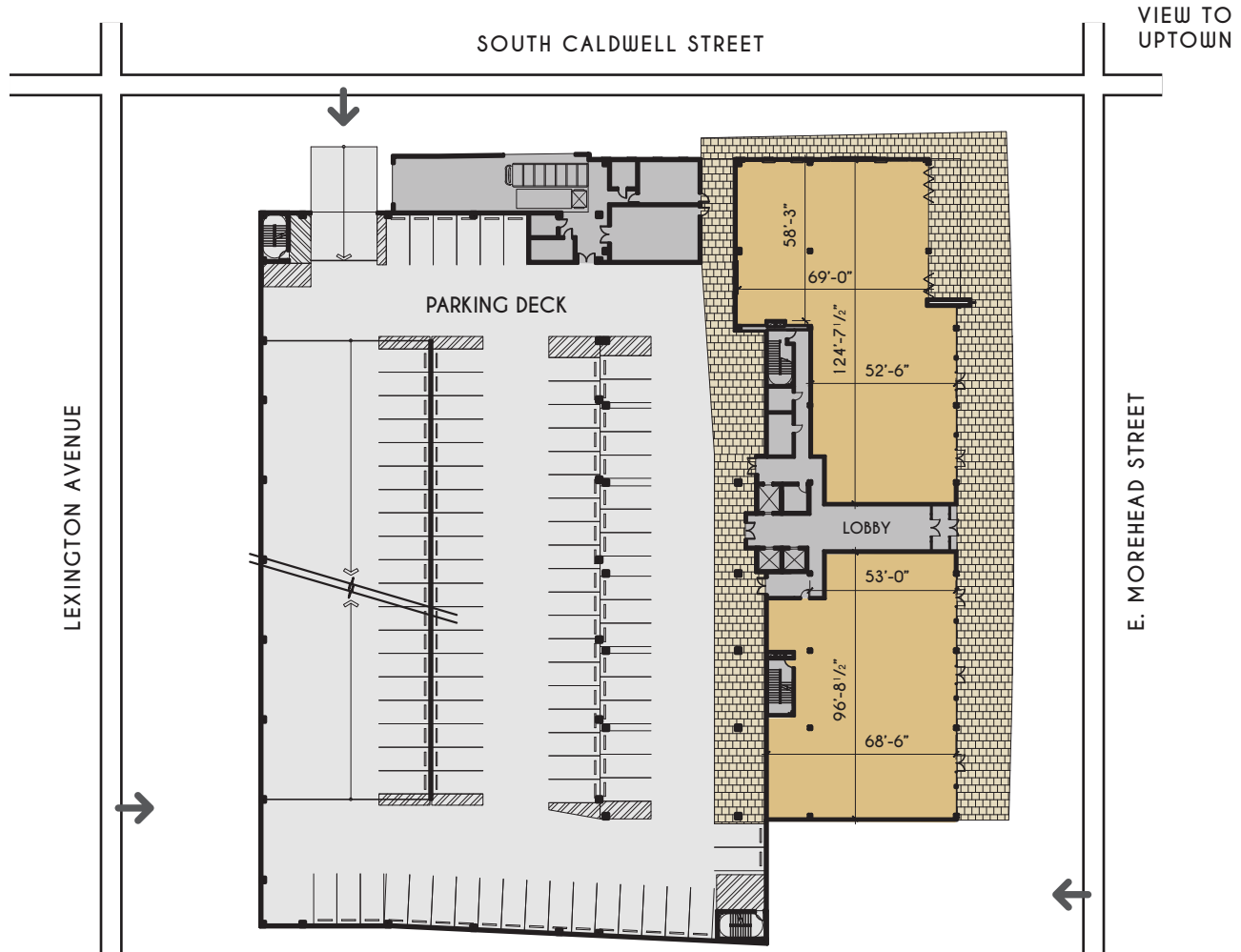

500 EAST MOREHEAD SITE PLAN



- 7-story, +/- 180,000-square-foot office building
- +/- 15,000 square feet of ground floor retail including on-site coffee shop, casual lunch spot and upscale restaurant
- Convenient, free parking deck
- State-of-the-art conference center
- Three private outdoor terraces with spectacular views of Uptown and the lush tree canopy of Morehead Street
- On-site fitness center with men's and women's locker rooms
- 900-square-foot rooftop terrace with view of Uptown, South End and Dilworth
- Targeting LEED® Gold certification

Charlie Swanson - 704.926.1403 | charlie@beacondevelopment.com **or**
Kristy Venning - 704.926.1409 | kristy@beacondevelopment.com



610 East Morehead Street, Suite 250, Charlotte, NC 28202
 office: 704.597.7757 | fax: 704.598.6335
www.beacondevelopment.com

500EMOREHEAD.COM